



ELECTRIC KETTLE - U.S AND INTERNATIONAL

MODELS:

KEK1522OB0 (Onyx Black)
KEK1522MS0 (Medallion Silver)
KEK1522FP0 (Frosted Pearl)
KEK1522CA0 (Candy Apple)
5KEK1522EER0 (Empire Red)
5KEK1522EOB0 (Onyx Black)
5KEK1522EAC0 (Almond Creme)
5KEK1522EMS0 (Medallion Silver)
5KEK1522EFP0 (Frosted Pearl)

5KEK1522ECA0 (Candy Apple)
5KEK1522BER0 (Empire Red)
5KEK1522BOB0 (Onyx Black)
5KEK1522BAC0 (Almond Creme)
5KEK1522BMS0 (Medallion Silver)
5KEK1522BFP0 (Frosted Pearl)
5KEK1522BCA0 (Candy Apple)
5KEK1522ACA0 (Candy Apple)
5KEK1522AFP0 (Frosted Pearl)

UNIT PARTS

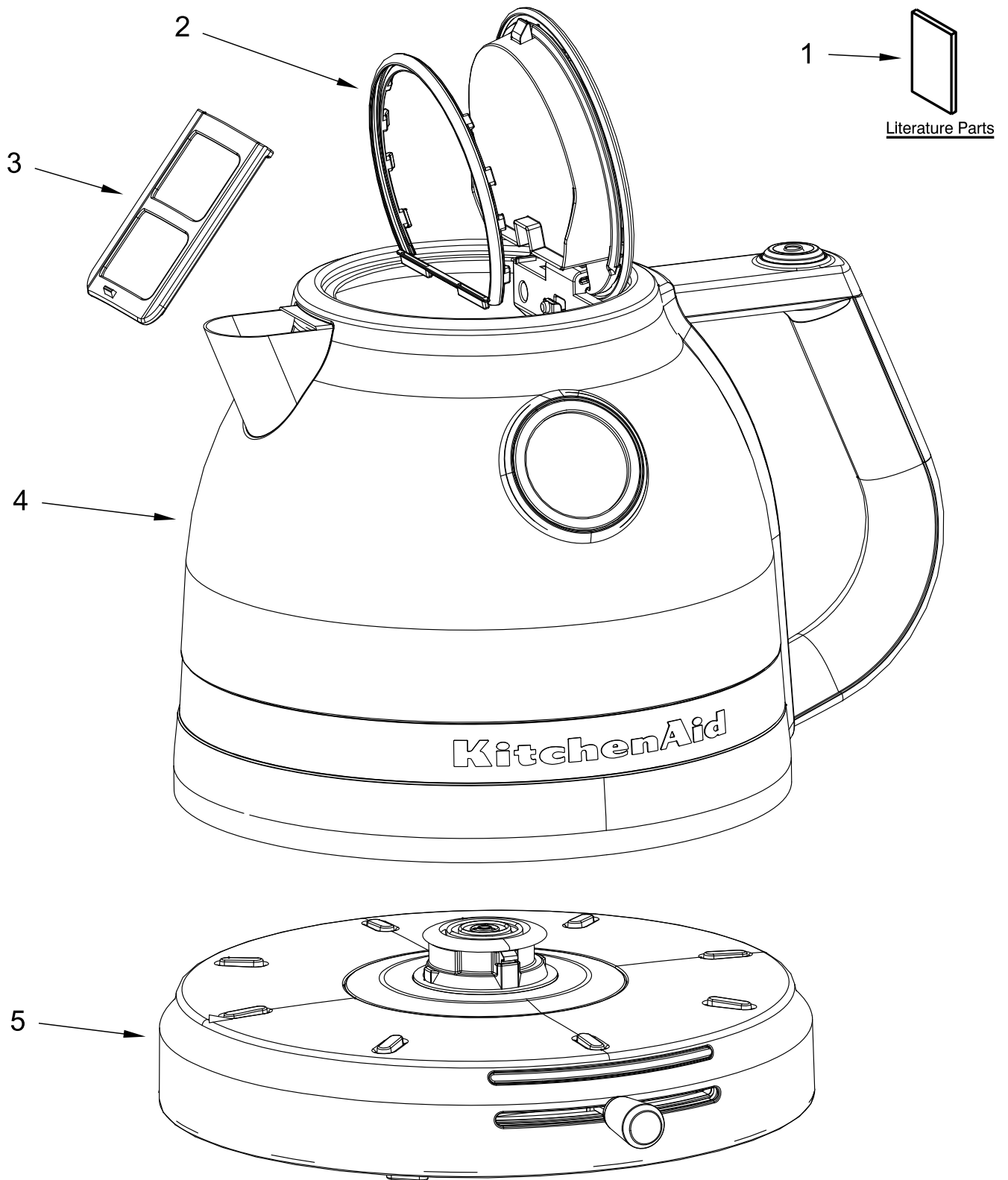

UNIT PARTS

<u>Illus. No.</u>	<u>Part No.</u>	<u>Description</u>
1		Literature Parts
	W10530534	Use and Care Guide, European
	W10548615	Use and Care Guide, U.S.
2	W10558309	Seal, Lid Ring
3	W10558310	Filter, Water

<u>Illus. No.</u>	<u>Part No.</u>	<u>Description</u>
4		Kettle
	W10590062	Onyx Black, U.S.
	W10590060	Medallion Silver, U.S.
	W10590064	Frosted Pearl, U.S.
	W10590056	Candy Apple, U.S.
	W10558321	Empire Red, European
	W10568108	Empire Red, British
	W10558324	Onyx Black, European
	W10568114	Onyx Black, British
	W10558322	Almond Creme, European
	W10568110	Almond Creme, British
	W10558323	Medallion Silver, European
	W10568112	Medallion Silver, British
	W10558319	Candy Apple, European
	W10568106	Candy Apple, British
	W10632864	Candy Apple, Australian)
	W10558325	Frosted Pearl, European
	W10568116	Frosted Pearl, British
	W10632867	Frosted Pearl, Australian

<u>Illus. No.</u>	<u>Part No.</u>	<u>Description</u>
5		Power Base
	W10590061	Onyx Black, U.S.
	W10590058	Medallion Silver, U.S.
	W10590063	Frosted Pearl, U.S.
	W10590055	Candy Apple, U.S.
	W10558312	Empire Red, European
	W10568107	Empire Red, British
	W10558317	Onyx Black, European
	W10568113	Onyx Black, British
	W10558313	Almond Creme, European
	W10568109	Almond Creme, British
	W10558315	Medallion Silver, European
	W10568111	Medallion Silver, British
	W10558318	Frosted Pearl, European
	W10568115	Frosted Pearl, British
	W10632865	Frosted Pearl, Australian
	W10558311	Candy Apple, European
	W10568103	Candy Apple, British
	W10632863	Candy Apple, Australian